



Pressure Supervisory Switches • 500 psi [34.5 bar]

designed for use with

3M™ Novec™ 1230 Fire Protection Fluid

Description

The switch is used to monitor the pressure within the Clean Agent Cylinder. If the cylinder to which the switch is attached leaks, and its pressure drops below 260 PSI, the switch contacts will activate, providing a signal to the Release Control Panel to indicate Clean Agent Cylinder's loss of pressure and or leakages.

Electrical Rating

240 VAC – 5.8 FLA 34.8 LRA
120 VAC – 2.9 FLA 15 LRA
120/277 VAC – 5 AMPS
24AC – 125VA Pilot Duty
28DC – 2 AMPS

Characteristics:

FTF-503001 Normally Closed
FTF-503002 Normally Open

Temperature Range

Ambient -20°F to +150°F [-29°C to + 65°C]
Fluid -65°F to +275°F [-54°C to + 135°C]

Others

Actuation Pressure 320 ± 10 PSI (22 BAR)
Release Pressure 260 ± 10 (18 BAR)

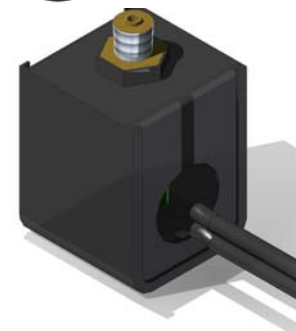

P/N: FTF 503001/FTF 503002